



PROFESSIONAL TOOLS ALL OVER THE WORLD

RICAMBI E LAVORAZIONI SUPPLEMENTARI > 10





CS

Profile turnover knives



HW profiled turnover knives • Available in different sizes • To mount on cutterheads TS and PS • Measures and tolerances of production are in observance of the UNI and ISO rules.

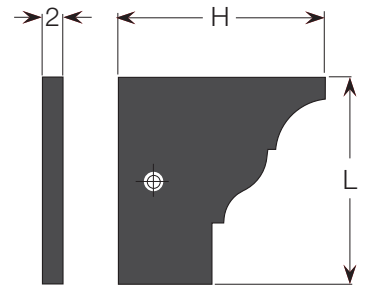

• Example profile turnover knives

HWM

L	H	Code	per unit ord.6 pcs	per unit ord.12 pcs	per unit ord.24 pcs	per unit ord.48 pcs	per unit ord.96 pcs
20	20	CS2020					
20	25	CS2025					
20	30	CS2030					
20	35	CS2035					
25	20	CS2520					
25	25	CS2525					
25	30	CS2530					
25	35	CS2535					
30	20	CS3020					
30	25	CS3025					
30	30	CS3030					
30	35	CS3035					
30	40	CS3040					
35	20	CS3520					
35	25	CS3525					
35	30	CS3530					
35	35	CS3535					
35	40	CS3540					
40	20	CS4020					
40	25	CS4025					
40	30	CS4030					
40	35	CS4035					
40	40	CS4040					
40	45	CS4045					
50	20	CS5020					
50	25	CS5025					
50	30	CS5030					
50	35	CS5035					
50	40	CS5040					
50	45	CS5045					
50	50	CS5050					
60	20	CS6020					
60	25	CS6025					
60	30	CS6030					
60	35	CS6035					
60	40	CS6040					
80	20	CS8020					
80	25	CS8025					
80	30	CS8030					
80	35	CS8035					
80	40	CS8040					
Spec.		CS99*					



C010

HW planing knives

Ground and polished with excellent finishing • Available in different sizes • Suitable for working wood, laminates and such • Can be used planer on cutterheads art.T204 and T204H • Measures and tolerances of production are in observance of the UNI and ISO rules.



HW

L	Code
60	C010M60
80	C010M80
100	C010M100
110	C010M110
120	C010M120
130	C010M130
140	C010M140
150	C010M150
160	C010M160
170	C010M170
180	C010M180
200	C010M200
210	C010M210
230	C010M230
300	C010M300
350	C010M350
400	C010M400
410	C010M410
500	C010M500
510	C010M510
530	C010M530
600	C010M600
610	C010M610
630	C010M630
640	C010M640
710	C010M710
Spec.	C010M99*



C011

HS planing knives

Ground and polished with excellent finishing • Available in different sizes • Suitable for working wood • Can be used planer on cutterheads art.T204 and T204H • Measures and tolerances of production are in observance of the UNI and ISO rules.

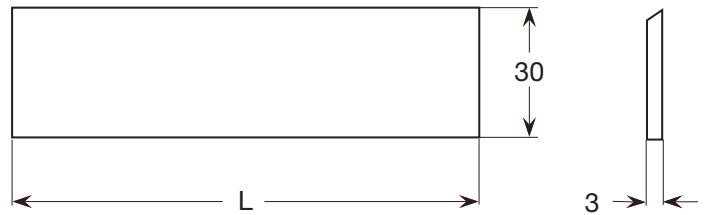

HS

L	Code
60	C011S60
80	C011S80
100	C011S100
110	C011S110
120	C011S120
130	C011S130
140	C011S140
150	C011S150
160	C011S160
170	C011S170
180	C011S180
200	C011S200
210	C011S210
230	C011S230
300	C011S300
350	C011S350
400	C011S400
410	C011S410
500	C011S500
510	C011S510
530	C011S530
600	C011S600
610	C011S610
630	C011S630
640	C011S640
710	C011S710
800	C011S800
1000	C011S1000
Spec.	C011S99*



C013

HS planing knives

Ground and polished with excellent finishing • Available in different sizes • Suitable for working wood • Can be used on planer cutterheads art.T204 and T204H • Measures and tolerances of production are in observance of the UNI and ISO rules.

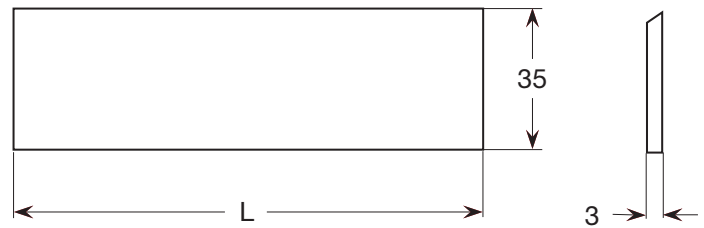

HS

L	Code
60	C013S60
80	C013S80
100	C013S100
110	C013S110
120	C013S120
130	C013S130
140	C013S140
150	C013S150
160	C013S160
170	C013S170
180	C013S180
200	C013S200
210	C013S210
230	C013S230
300	C013S300
350	C013S350
400	C013S400
410	C013S410
500	C013S500
510	C013S510
530	C013S530
600	C013S600
610	C013S610
630	C013S630
640	C013S640
710	C013S710
800	C013S800
1000	C013S1000
Spec.	C013S99*



C016

HWM reversable knives

Ground and polished with excellent finishing • Available in different sizes • Suitable for working chipboard, laminated and such • Can be used on cutterheads • Measures and tolerances of production are in observance of the UNI and ISO rules.

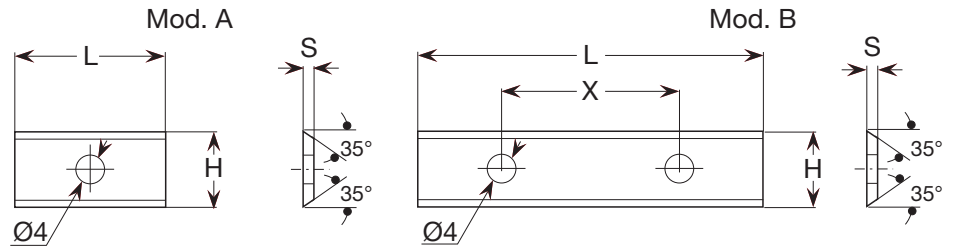

HWM

Knives L=12 mm with 4 cleared side angles.

L	H	S	X	Mod	Code
7,5	9	1,5		A	C016M759
9,6	9	1,5		A	C016M969
12	9	1,5		A	C016M129
14,6	9	1,5		A	C016M159
20	9	1,5		A	C016M209
30	9	1,5	14	B	C016M309
40	9	1,5	26	B	C016M409
50	9	1,5	26	B	C016M509
60	9	1,5	26	B	C016M609
Spec.					C016M99*

C017

HWM reversable knives

Ground and polished with excellent finishing • Available in different sizes • Suitable for working soft wood • Can be used on cutterheads • Measures and tolerances of production are in observance of the UNI and ISO rules.

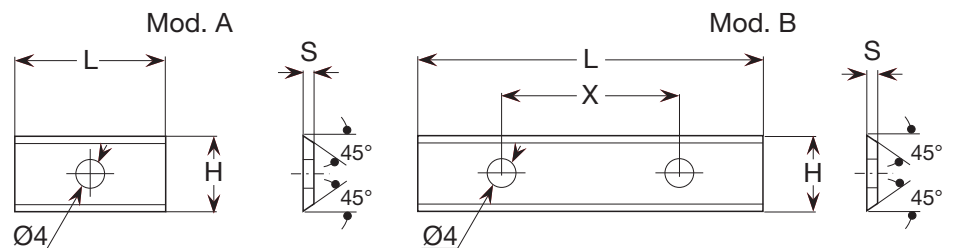

HWM

Knives L=12 mm with 4 cleared side angles.

L	H	S	X	Mod	Code
7,5	12	1,5		A	C017M7512
9,6	12	1,5		A	C017M9612
12	12	1,5		A	C017M1212
15	12	1,5		A	C017M1512
20	12	1,5		A	C017M2012
30	12	1,5	14	B	C017M3012
40	12	1,5	26	B	C017M4012
50	12	1,5	26	B	C017M5012
60	12	1,5	26	B	C017M6012
Spec.					C017M99*



C019 HWM reversable knives

Ground and polished with excellent finishing • Available in different sizes • Suitable for working wood • Can be used on cutterheads • Measures and tolerances of production are in observance of the UNI and ISO rules.

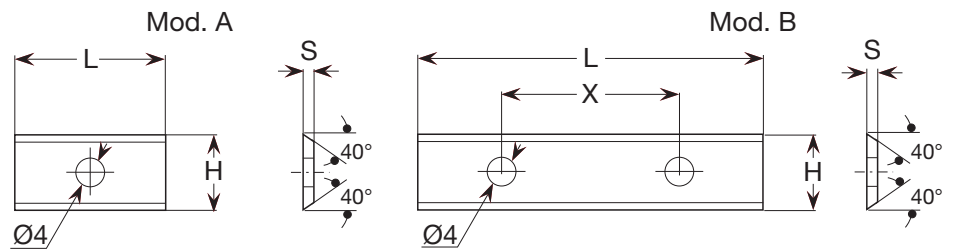

HWM

Knives L=12 mm with 4 cleared side angles.

L	H	S	X	Mod	Code
12	12	1,5		A	C019M1212
20	12	1,5		A	C019M2012
30	12	1,5	14	B	C019M3012
40	12	1,5	26	B	C019M4012
50	12	1,5	26	B	C019M5012
60	12	1,5	26	B	C019M6012
Spec.					C019M99*

C020 HWM reversable knives

Ground and polished with excellent finishing • Available in different sizes • Suitable for working chipboard, laminated and such • Can be used on cutterheads • Measures and tolerances of production are in observance of the UNI and ISO rules.

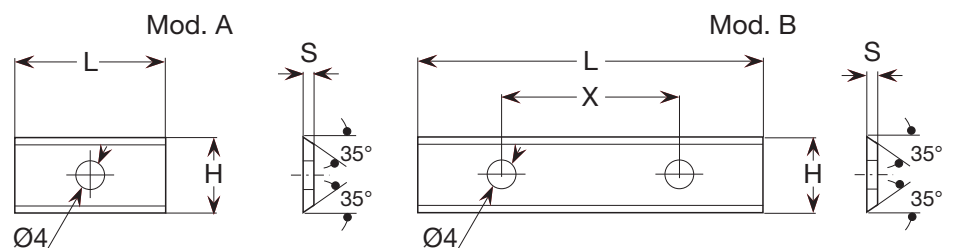

HWM

Knives L=12 mm with 4 cleared side angles.

L	H	S	X	Mod	Code
7,5	12	1,5		A	C020M7512
9,6	12	1,5		A	C020M9612
12	12	1,5		A	C020M1212
15	12	1,5		A	C020M1512
20	12	1,5		A	C020M2012
25	12	1,5		A	C020M2512
30	12	1,5	14	B	C020M3012
40	12	1,5	26	B	C020M4012
50	12	1,5	26	B	C020M5012
60	12	1,5	26	B	C020M6012
80	13	2,2	60	B	C020M8013
100	13	2,2	60	B	C020M10013
120	13	2,2	60	B	C020M12013
Spec.					C020M99*



C022

HWM reversable knives

Ground and polished with excellent finishing • Available in different sizes • Good tool life • Suitable for working chipboard, laminated and such • Can be used on cutterheads • Measures and tolerances of production are in observance of the UNI and ISO rules.

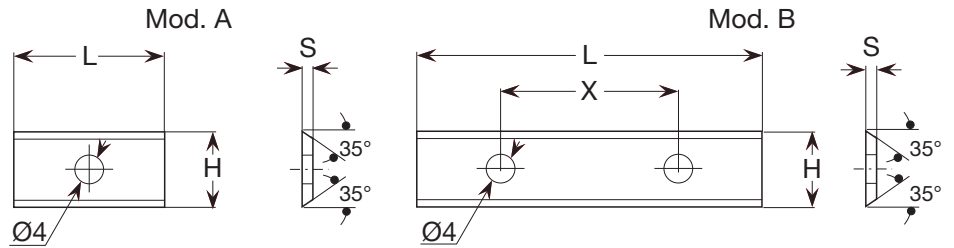

HWM

Knives L=12 mm with 4 cleared side angles.

L	H	S	X	Mod	Code
7,5	12	1,5		A	C022M7512
12	12	1,5		A	C022M1212
15	12	1,5		A	C022M1512
20	12	1,5		A	C022M2012
30	12	1,5	14	B	C022M3012
50	12	1,5	26	B	C022M5012
60	12	1,5	26	B	C022M6012
Spec.					C022M99*

C024

HWM reversable knives – high efficiency

Ground and polished with excellent finishing • Available in different sizes • Excellent tool life • Suitable for working chipboard, laminated and such • Can be used on cutterheads • Measures and tolerances of production are in observance of the UNI and ISO rules.

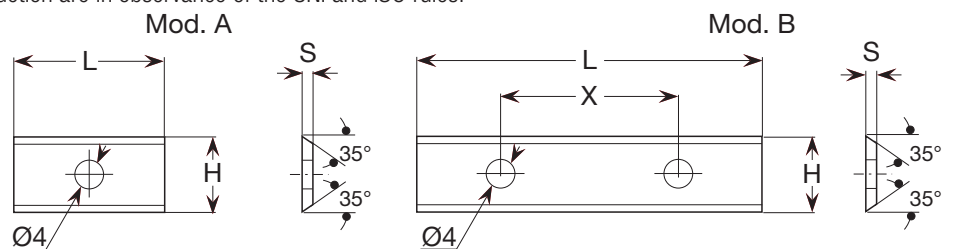

HWM

L	H	S	X	Mod	Code
20	12	1,5		A	C024M2012
30	12	1,5	14	B	C024M3012
50	12	1,5	26	B	C024M5012
Spec.					C024M99*



C025

HWM reversable knives – sides cleared

Ground and polished with excellent finishing • Bottom clearance angle, all 4 sides can cut • Available in different sizes • Good tool life • Indicated for frontal cutting chipboard, laminated and such • Measures and tolerances of production are in observance of the UNI and ISO rules.

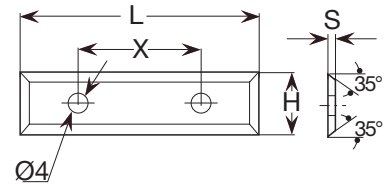

HWM

L	H	S	X	Code
29,5	12	1,5	14	C025M29512
49,5	12	1,5	26	C025M49512
Spec.				C025M99*

C028

HWM reversable knives

Ground and polished with excellent finishing • Available in different sizes • Suitable for working wood • Can be used on cutterheads • Measures and tolerances of production are in observance of the UNI and ISO rules.

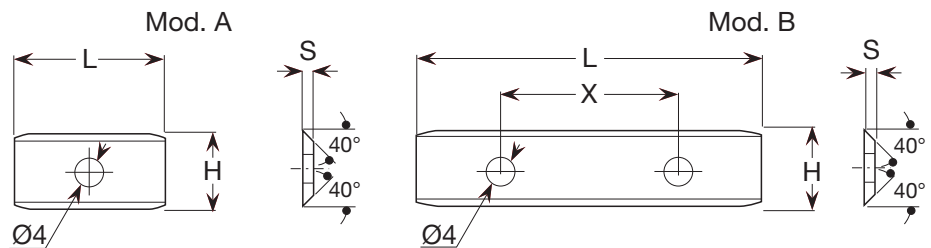

HWM

L	H	S	X	Mod	Code
24	12	1,5		A	C028M2412
50	12	1,5	26	B	C028M5012
Spec.					C028M99*



C030 HWM reversable knives

Ground and polished with excellent finishing • Available in different sizes • Suitable for working wood • Can be used on router bit cutterheads • Measures and tolerances of production are in observance of the UNI and ISO rules.

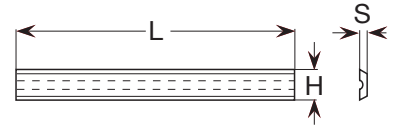

HWM

L	H	S	Code
12	5,5	1,1	C030M12
20	5,5	1,1	C030M20
30	5,5	1,1	C030M30
40	5,5	1,1	C030M40
50	5,5	1,1	C030M50
Spec.			C030M99*

C032 HWM reversable knives

Ground and polished with excellent finishing • Available in different sizes • Suitable for working wood • Can be used on router bit cutterheads • Measures and tolerances of production are in observance of the UNI and ISO rules.

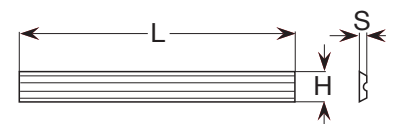

HWM

L	H	S	Code
12	5,5	1,1	C032M12
20	5,5	1,1	C032M20
30	5,5	1,1	C032M30
40	5,5	1,1	C032M40
50	5,5	1,1	C032M50
82	5,5	1,1	C032M82
Spec.			C032M99*



C035 HWM reversable knives

Ground and polished with excellent finishing • Bottom clearance angle, all 4 sides can cut • Available in different sizes • To mount on router bits cutterheads • Measures and tolerances of production are in observance of the UNI and ISO rules.

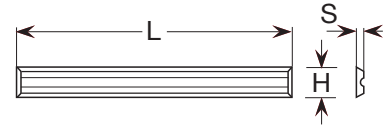

HWM

L	H	S	Code
29,5	5,5	1,1	C035M295
49,5	5,5	1,1	C035M495
Spec.			C035M99*

C040 HWM reversable knives

Ground and polished with excellent finishing • 4 sides clearance angle • Available in different sizes • To mount on cutterheads • Measures and tolerances of production are in observance of the UNI and ISO rules.

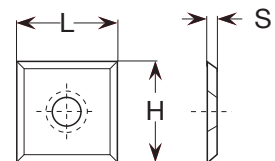

HWM

L	H	S	Code
14	14	1,2	C040M141,2
14	14	2	C040M142
Spec.			C040M99*



C042

HWM triangular spurs



Ground and polished with excellent finishing • Available in different sizes • To mount on cutterheads • Measures and tolerances of production are in observance of the UNI and ISO rules.

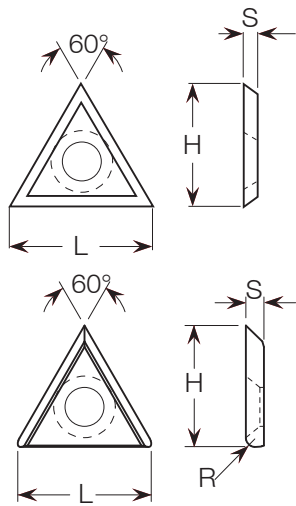

HWM

L	H	S	Code
22	19	2	C042M22
Spec.			C042M99*

L	H	S	R	Code
21,9	19	2,5	1,5	C042M219
Spec.				C042M99*

C044

HWM reversible inserts



Ground and polished with excellent finishing • Available in different sizes • To mount on cutterheads • Measures and tolerances of production are in observance of the UNI and ISO rules.

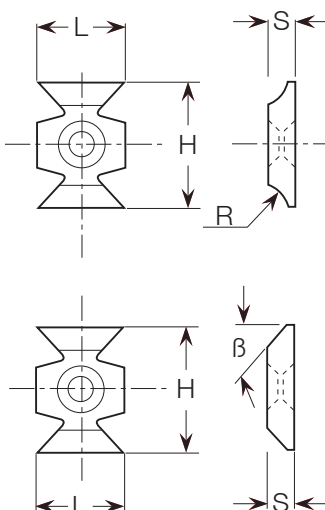

HWM

L	H	S	R	Code
16	22	5	1,5	C044M22R1,5
16	22	5	2	C044M22R2
16	22	5	3	C044M22R3
Spec.				C044M99*

L	H	S	β	Code
16	22	5	45°	C044M22S
Spec.				C044M99*



C046

HWM reversible grooving inserts



Ground and polished with excellent finishing • Available in different sizes • To mount on cutterheads • Measures and tolerances of production are in observance of the UNI and ISO rules.

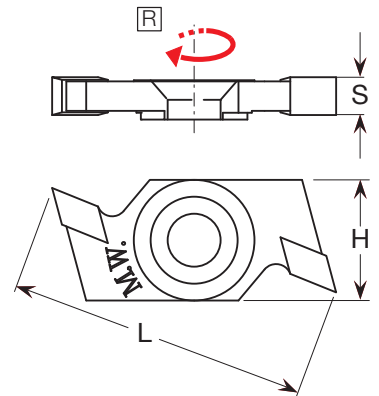

HWM

S	H	L	Left code	Right code
3	16	40	C046M3L	C046M3R
4	16	40	C046M4L	C046M4R
5	16	40	C046M5L	C046M5R
6	16	40	C046M6L	C046M6R
Spec.			C046M99L*	C046M99R*

C047

HWM reversible grooving inserts



Ground and polished with excellent finishing • Available in different sizes • To mount on cutterheads • Measures and tolerances of production are in observance of the UNI and ISO rules.

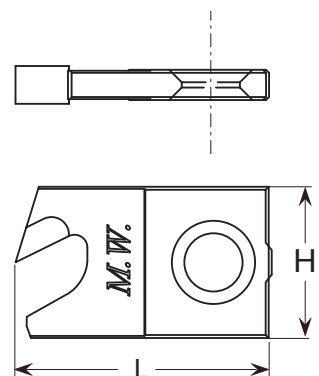

HWM

S	H	L	Code
3	20	25,6	C047M3
4	20	25,6	C047M4
5	20	25,6	C047M5
6	20	25,6	C047M6
Spec.			C047M99*



C048

HWM reversible grooving inserts



Ground and polished with excellent finishing • Available in different sizes • To mount on cutterheads • Measures and tolerances of production are in observance of the UNI and ISO rules.

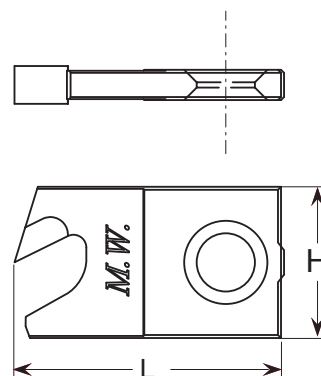

HW

S	H	L	Code
3	20	35,6	C048M3
4	20	35,6	C048M4
5	20	35,6	C048M5
6	20	35,6	C048M6
Spec.			C048M99*



C206

Profiling knives for T206–T206H–T206W cutterheads

HS knurled knives (thickness 8 mm) • Available in different sizes • Supplied standard or profiled • Suitable for working solid wood • To mount on cutterheads T206, T206H, T206W • Measures and tolerances of production are in observance of the UNI and ISO rules.

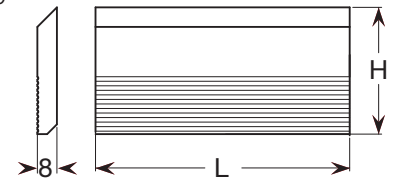

HS

L	H	Code
60	50	C206S06050
80	50	C206S08050
100	50	C206S10050
130	50	C206S13050
150	50	C206S15050
180	50	C206S18050
230	50	C206S23050
650	50	C206S65050
60	60	C206S06060
80	60	C206S08060
100	60	C206S10060
130	60	C206S13060
150	60	C206S15060
180	60	C206S18060
230	60	C206S23060
650	60	C206S65060
60	70	C206S06070
80	70	C206S08070
100	70	C206S10070
130	70	C206S13070
150	70	C206S15070
180	70	C206S18070
230	70	C206S23070
650	70	C206S65070
Spec.		C206S99*

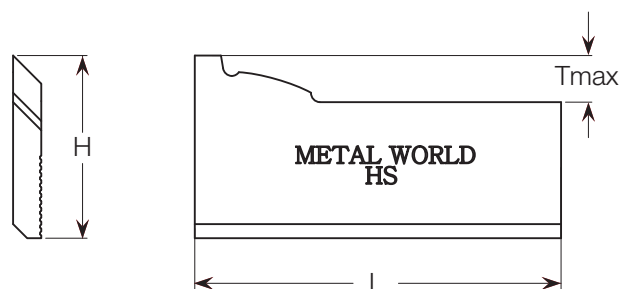

H	Tmax
50	12
60	20
70	30

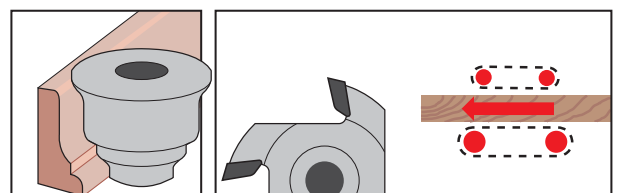



C206

HW profilable knives for T206–T206H–T206W cutterheads

HW knurled knives (thickness 8 mm) • Available in different sizes • Supplied standard or profiled • Suitable for working solid wood • To mount on cutterheads T206, T206H, T206W • Measures and tolerances of production are in observance of the UNI and ISO rules.

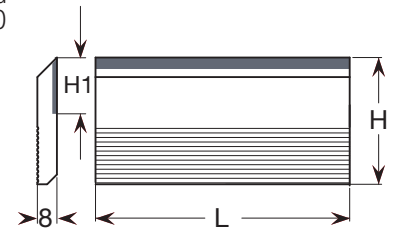
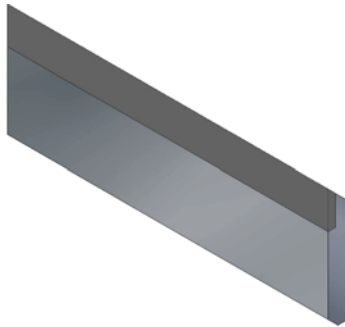

HW

L	H	H1	Code
60	50	15	C206M0605015
80	50	15	C206M0805015
100	50	15	C206M1005015
130	50	15	C206M1305015
150	50	15	C206M1505015
180	50	15	C206M1805015
230	50	15	C206M2305015
60	50	20	C206M0605020
80	50	20	C206M0805020
100	50	20	C206M1005020
130	50	20	C206M1305020
150	50	20	C206M1505020
180	50	20	C206M1805020
230	50	20	C206M2305020
60	60	25	C206M0606025
80	60	25	C206M0806025
100	60	25	C206M1006025
130	60	25	C206M1306025
150	60	25	C206M1506025
180	60	25	C206M1806025
230	60	25	C206M2306025
Spec.			C206M99*

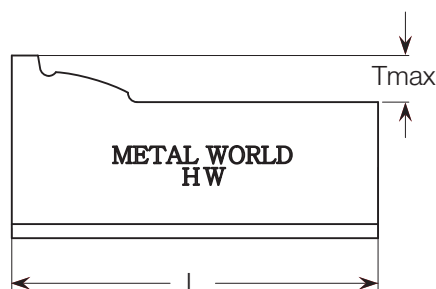
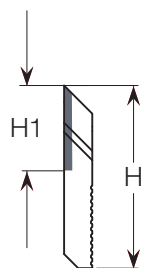

H	H1	Tmax
50	15	7
50	20	12
60	25	17

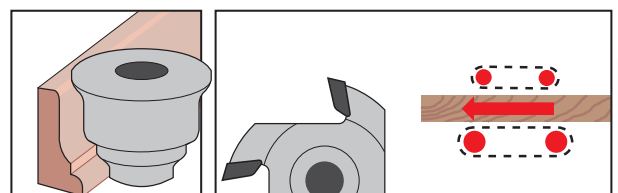



C206

HW profilable knives for T206–T206H–T206W cutterheads

HW knurled knives (thickness 8 mm) • Available in different sizes • Supplied standard or profiled • Suitable for working solid wood • To mount on cutterheads T206, T206H, T206W • Measures and tollerances of production are in observance of the UNI and ISO rules.

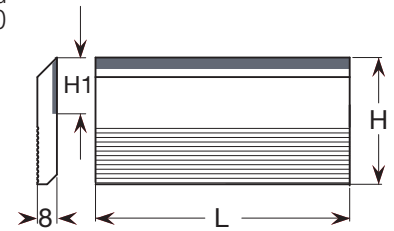

HW

L	H	H1	Code
60	60	30	C206M0606030
80	60	30	C206M0806030
100	60	30	C206M1006030
130	60	30	C206M1306030
150	60	30	C206M1506030
180	60	30	C206M1806030
230	60	30	C206M2306030
60	70	30	C206M0607030
80	70	30	C206M0807030
100	70	30	C206M1007030
130	70	30	C206M1307030
150	70	30	C206M1507030
180	70	30	C206M1807030
230	70	30	C206M2307030
60	70	35	C206M0607035
80	70	35	C206M0807035
100	70	35	C206M1007035
130	70	35	C206M1307035
150	70	35	C206M1507035
180	70	35	C206M1807035
230	70	35	C206M2307035
Spec.			C206M99*

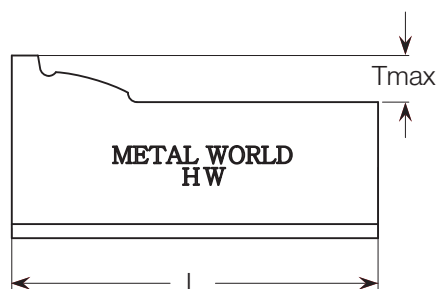
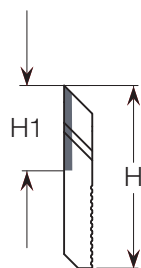

H	H1	Tmax
60	30	22
70	30	22
70	35	27

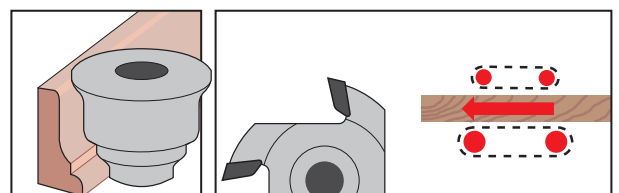



A010

Spacing collars

Obtained from steel with a high quality • Available in different sizes
 • Surfaces completely ground • To use with cutter sets and other tools
 • Measures and tolerances of production are in observance of the UNI and ISO rules.

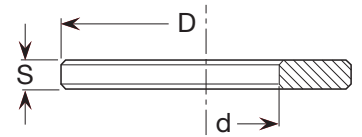

d	S	D	Code
12	0,1	24	A0101201
12	0,2	24	A0101202
12	0,5	24	A0101205
12	1	24	A010121
16	0,1	30	A0101601
16	0,2	30	A0101602
16	0,5	30	A0101605
16	1	30	A010161
20	0,1	35	A0102001
20	0,2	35	A0102002
20	0,5	35	A0102005
20	1	35	A010201
25	0,1	40	A0102501
25	0,2	40	A0102502
25	0,5	40	A0102505
25	1	40	A010251
30	0,1	50	A0103001
30	0,2	50	A0103002
30	0,5	50	A0103005
30	1	50	A010301
30	2	50	A010302
30	3	50	A010303
30	4	50	A010304
30	5	50	A010305
30	6	50	A010306
30	7	50	A010307
30	8	50	A010308
30	9	50	A010309
30	10	50	A0103010
30	12	50	A0103012
30	15	50	A0103015
30	20	50	A0103020
35	0,1	55	A0103501
35	0,2	55	A0103502
35	0,5	55	A0103505
35	1	55	A010351
35	2	55	A010352
35	3	55	A010353
35	4	55	A010354
35	5	55	A010355
35	6	55	A010356

d	S	D	Code
35	7	55	A010357
35	8	55	A010358
35	9	55	A010359
35	10	55	A0103510
35	12	55	A0103512
35	15	55	A0103515
35	20	55	A0103520
40	0,1	60	A0104001
40	0,2	60	A0104002
40	0,5	60	A0104005
40	1	60	A010401
40	2	60	A010402
40	3	60	A010403
40	4	60	A010404
40	5	60	A010405
40	6	60	A010406
40	7	60	A010407
40	8	60	A010408
40	9	60	A010409
40	10	60	A0104010
40	12	60	A0104012
40	15	60	A0104015
40	20	60	A0104020
50	0,1	70	A0105001
50	0,2	70	A0105002
50	0,5	70	A0105005
50	1	70	A010501
50	2	70	A010502
50	3	70	A010503
50	4	70	A010504
50	5	70	A010505
50	6	70	A010506
50	7	70	A010507
50	8	70	A010508
50	9	70	A010509
50	10	70	A0105010
50	12	70	A0105012
50	15	70	A0105015
50	20	70	A0105020
Spec.			A01099*



CH Wrenches

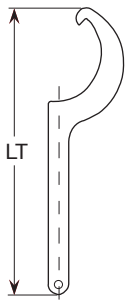

S	LT	Code
52-55	205	CH052
58-62	240	CH058
Spec.		CH99*

CHET "T" allen wrenches

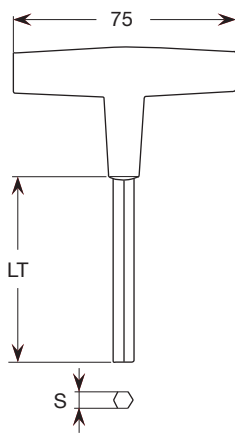

S	LT	Code
2,5	90	CHET25
3	90	CHET03
4	100	CHET04
5	110	CHET05
6	110	CHET06
6	200	CHET06H
8	200	CHET08H
10	200	CHET10H
Spec.		CHET99*

CHTC Torx wrenches

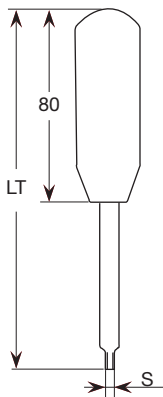

S	LT	Code
T9	130	CHTC09
T10	150	CHTC10
T15	160	CHTC15
T20	180	CHTC20
Spec.		CHTC99*

CHTT "T" torx wrenches

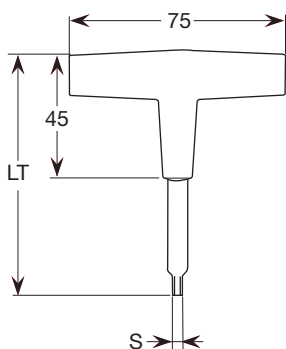

S	LT	Code
T9	90	CHTT09
T10	95	CHTT10
T15	95	CHTT15
T20	150	CHTT20
T25	150	CHTT25
Spec.		CHTT99*



SUPP

Adjustable supports for bevel/radius inserts

Obtained from hardened and tempered steel • Suitable for mounting inserts on any type of cutterheads • The support is supplied without knives • Measures and tolerances of production are in observance of the UNI and ISO rules.

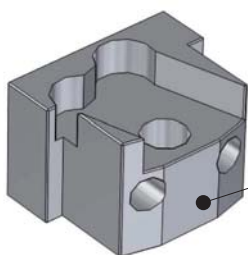

SUPPSR171116

Right code	Left code
SUPPSR171104	SUPPSR171116



Code
SUPPSM1



Code
SUPPSM2

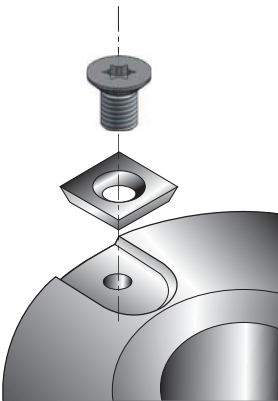

Execution of spur seats C040.

Nr. of seats

2	_____
3	_____
4	_____
6	_____
8	_____

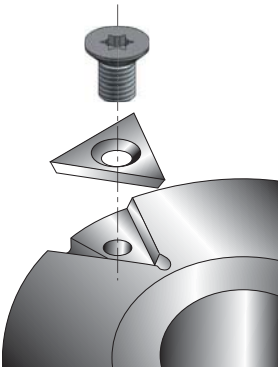

Execution of seats for triangular spurs C042

Nr. seats

2	_____
3	_____
4	_____
6	_____
8	_____

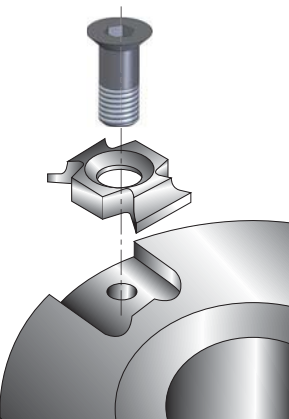

Execution of seats for bevel/radius inserts.

Nr. seats

2	_____
3	_____
4	_____
6	_____
8	_____



LAV

Additional working

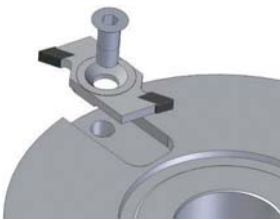

Execution of grooving insert seats C046 - C047 - C048.

Nr. seats

2	
3	
4	
6	

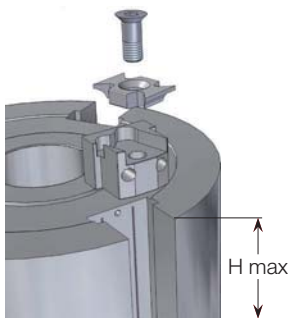

Execution of seats for adjustable supports for bevel/radius inserts C044.

Nr. sedi H max

2	50
3	50
4	50
2	100
3	100
4	100
2	150
3	150
4	150

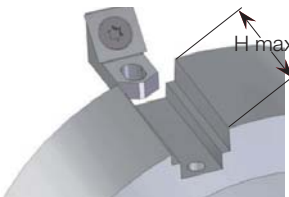

Execution of seats for adjustable supports and spurs C040.

Nr. sedi H max

2	50
3	50
4	50
6	50
2	100
3	100
4	100
6	100